

# ■ Maker Workstation

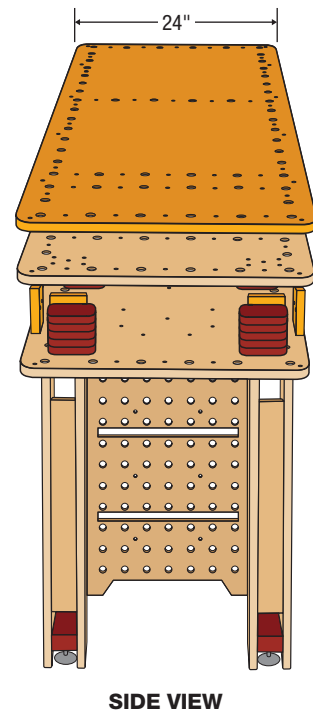

**It's a system that uses workstation "furniture" to position and hold work, customizable top and side plates, modules, fixtures, hardware, tool holding capability and accessories.**

# ■ Maker Workstation

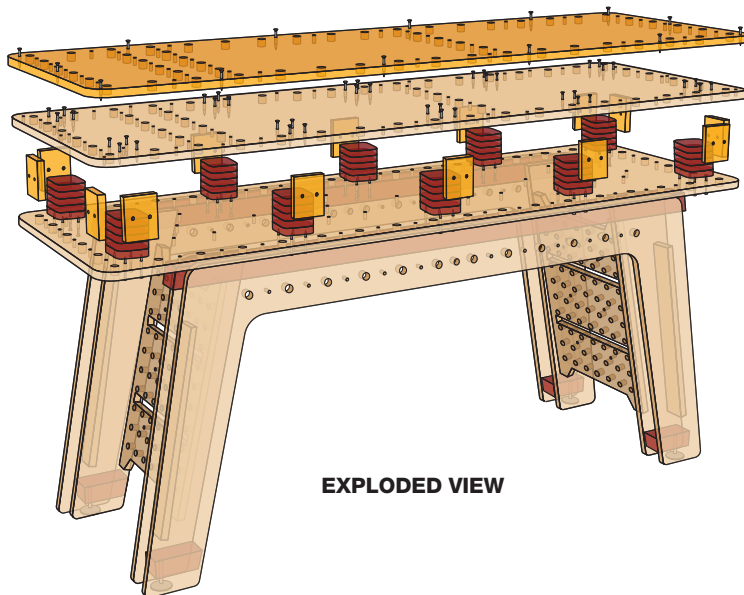
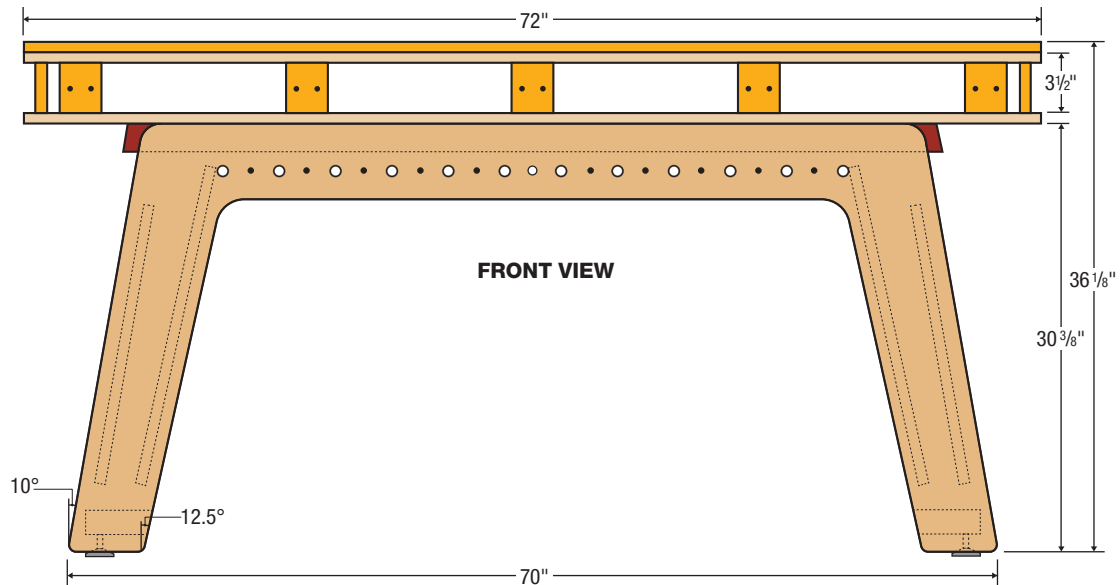
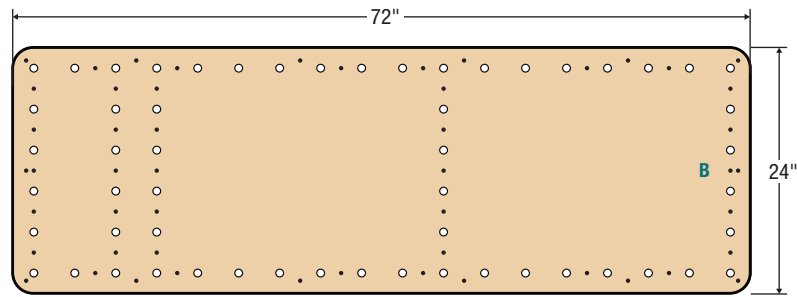

**MDF TOP**

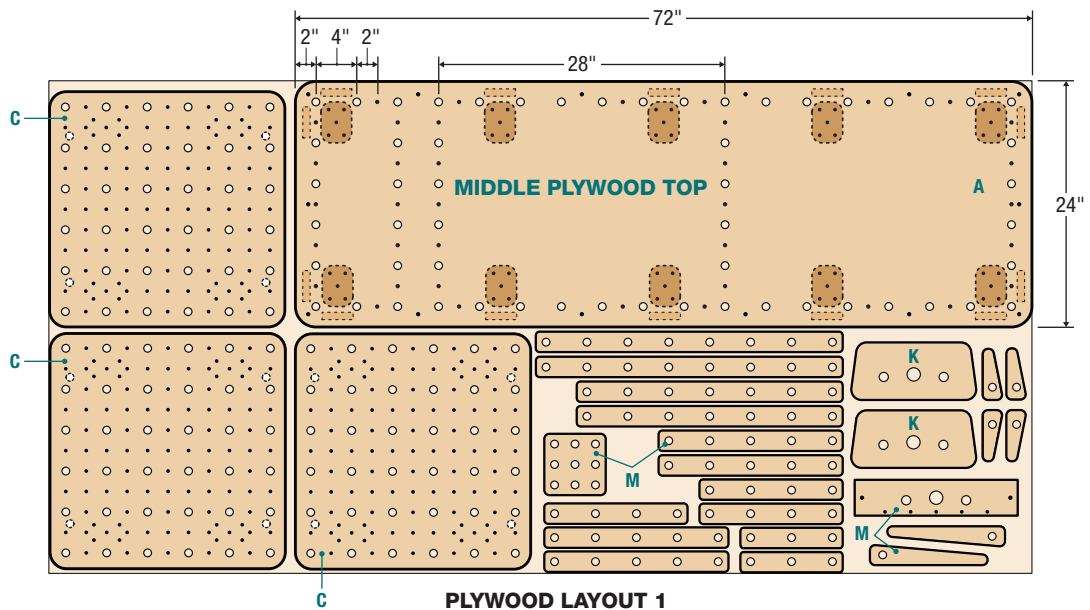

**PLYWOOD LAYOUT 1**

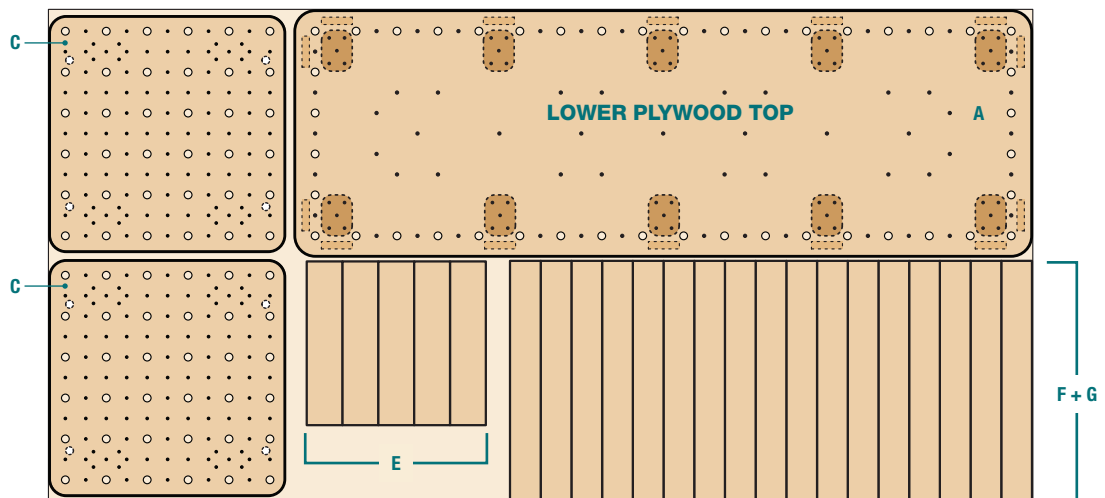

**PLYWOOD LAYOUT 2**

# Maker Workstation

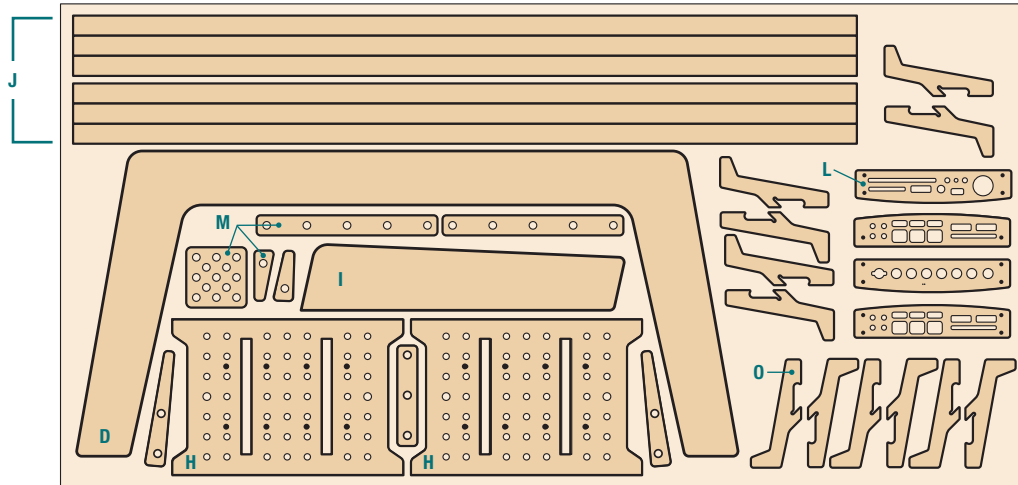

PLYWOOD LAYOUT 3

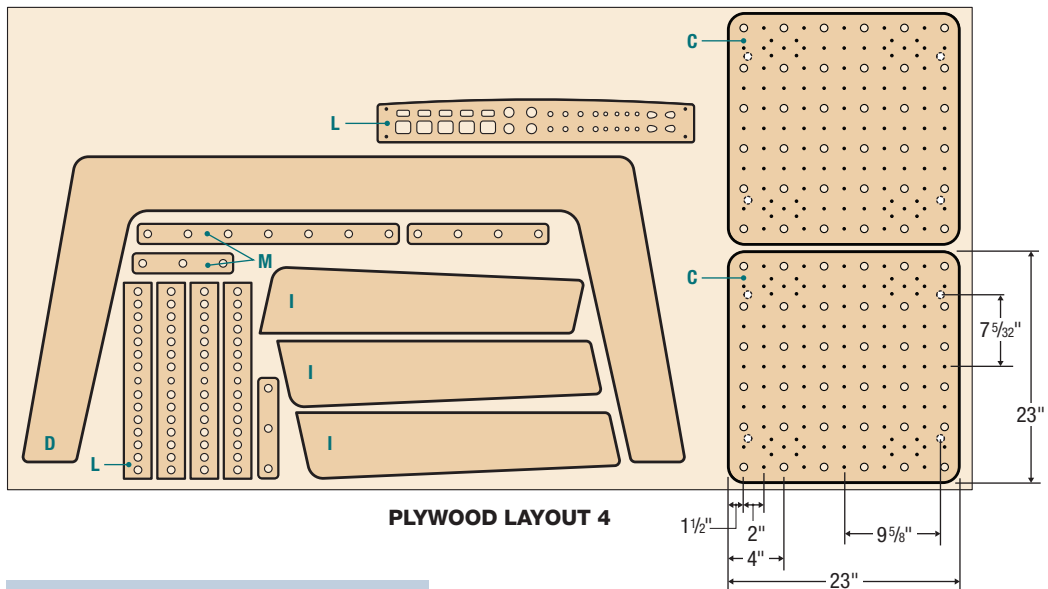

PLYWOOD LAYOUT 4

## Bench Parts

No.	Item	Dimensions (in.)		
		T	W	L
2	A Plywood Tops	3/4	24	72
1	B MDF Top	3/4	24	72
7	C Top Plates	3/4	23	23
2	D Outside Legs	3/4	30 1/2	60
2	E Side Plates	3/4	3 1/2	16
-	F Riser/Mount Stock	3/4	3	23
-	G Side Plate Mounts	3/4	3	4
-	H Side Stretchers	3/4	15 1/2	23
4	I Inside Legs	3/4	7 1/2	32
6	J Lamination Strips	3/4	2	72

## Bench Furniture

Item	
K	Vice Plates
L	Accessory Holders
M	Bench Furniture
N	Wedges
O	French Cleat Supports